



# Assembly Guide

## BYOB | Build Your Own Desk

Thank you for buying your BYOD kit. Before you start assembling your desk, we would like to tell you that please don't worry if you find it difficult to understand. You can always watch our explanatory video where we have explained it in more detail. You can also reach out to us for telephonic help.

You have received the following items in your package:

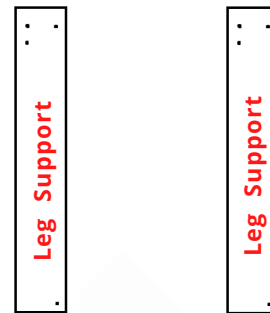
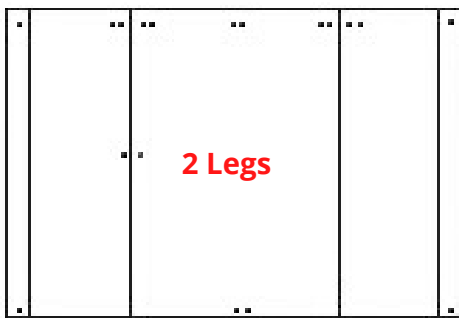

These pieces are marked as "**Left Leg**" and "**Right Leg**".

You have received 2 of these pieces: **Right Leg Support** & **Left Leg Support**.



You will use the **Centre Piece** to join both Legs.

This is the **table top** where you are going to work!

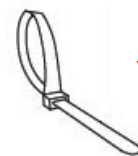

**18 Zip Ties**

**Back Support** will be attached at the back of the workstation for added sturdiness and stability.

You will use **15** of these ties to bind cardboard pieces together. We have put **3** extra ties as buffer - just in case you tie a wrong knot.

# Now that you have unpacked the kit, we will move towards assembling

The ideal method to assemble the desk is by following this guide while also watching the assembly video for minute details.

## 1 - Fold "Right Leg" and Tie With "Right Leg Support"

Fold the **Right Leg** along the bends that are already provided. Fix the "Inner Side" of the **Right Leg Support** between the bends and tie using a Zip Tie. Repeat the process using the holes at the top-centre and bottom-centre (circled below) of the leg.

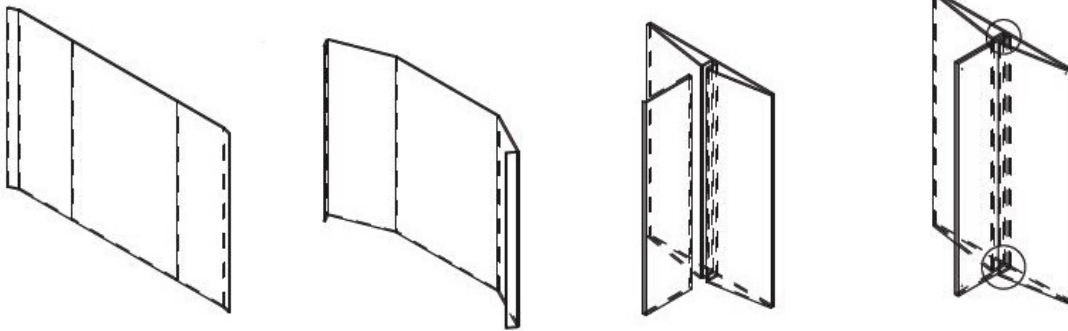

## 2 - Now Fold "Left Leg" and Tie With "Left Leg Support"

Now repeat the exact same process for the **Left Leg** and tie it with **Left Leg Support**. Tie the knots both at the top-centre and bottom-centre of the leg (as circled below). By looking at the labels on the Legs and Leg Support pieces, you would intuitively know which side is top and which side is bottom.

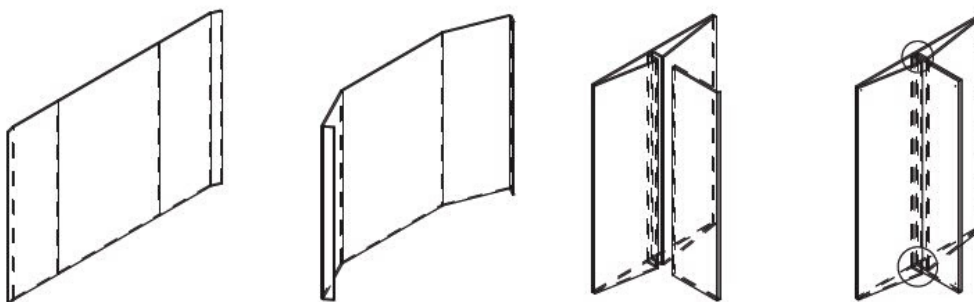

### 3 - Confused about how to use Zip Ties to tie a knot?

Please have a look at the illustration below to understand how to tie a knot.

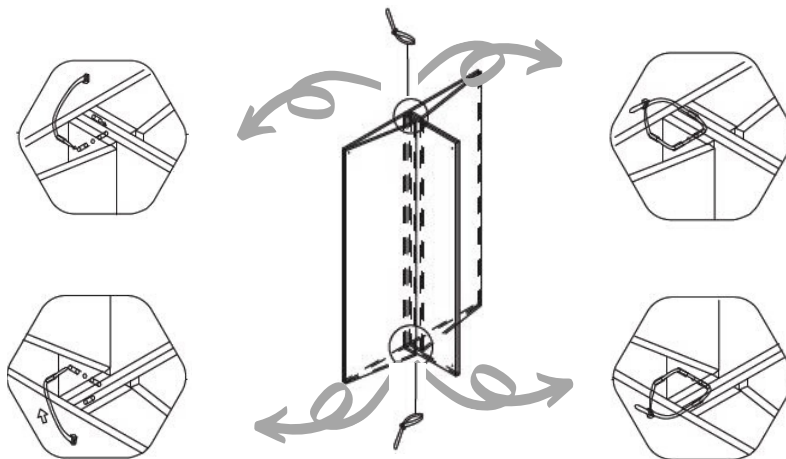

### 4 - Join both legs with Leg Supports

Now that you have joined the *Leg Supports*, put *Right Leg* and *Left Leg* in front of you and take out the **Centre Piece**. Join the *Centre Piece* with *Leg Supports*. A pair of holes on *Leg Supports* is marked where you have to join the centre piece.



### 5 - Now It's time to place the top

You have done the major work and the desk is taking shape now. It's time to place the **Top** on the structure you have made. Tie the top using Zip Ties from all four corners.

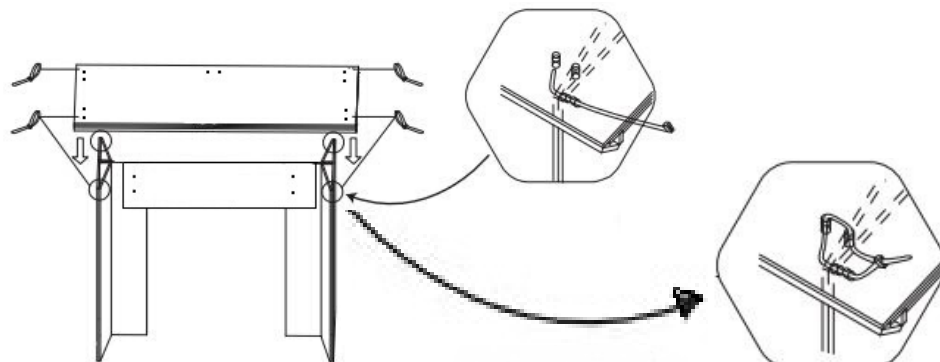

## 6 - You are almost done assembling your desk! The last step is to attach Back Support to make the desk sturdy!

Turn the desk around and attach **Back Support** at the back. Back support will be tied with legs at 4 points and with the top at 1 point as shown in the illustration below.

*Back View of the Desk*

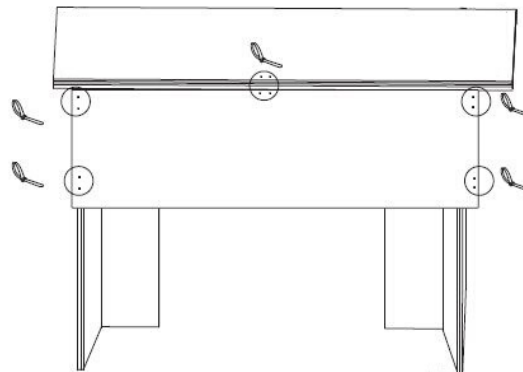

## 7 - Congratulation! Your desk is ready!

Your desk is now ready. You can place your favorite items on your desk and start working.



## You can always contact us just in case you need more help!

Please watch the detailed **assembly video** just in case you face any difficulty assembling the desk.

You can also call us and we would be more than happy to offer **telephonic help**.

For feedback and queries, you can always write to us at **hello@kickstart.pk**